

GALLERY

Benefitting from a glorious south-facing vista across the Telford Convention Quarter, the Gallery space at Telford International Centre is perfect for pre-dinner drinks.

It is also flexible enough to be used for dinners, lunch service or even small exhibitions.

Its size and proximity to all of the venue's main spaces means it is a great choice for any event.

GALLERY	
DIMENSIONS	30m x 19.5m
SIZE	585m ²
HEIGHT	2.4m+
THEATRE	-
CLASSROOM	-
BOARDROOM	-
RECEPTION	-
BANQUETING	-
CABARET	-

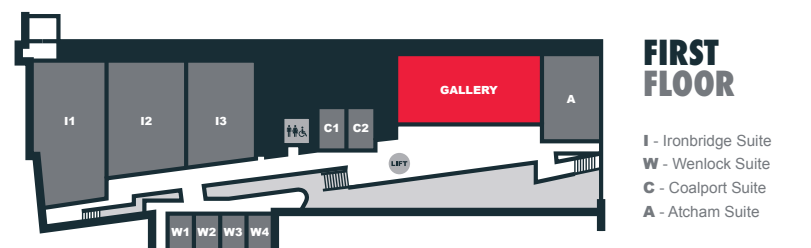
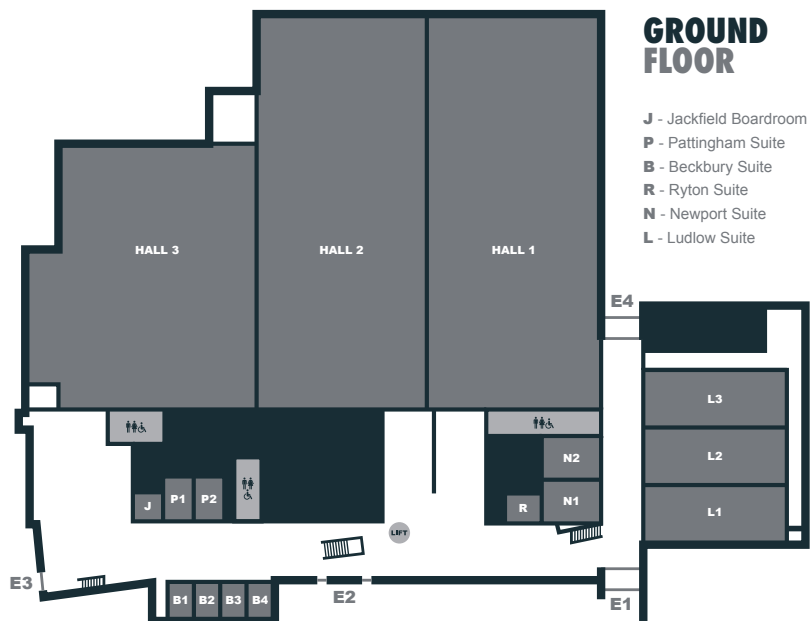

TELFORD. EVENT. READY.



telford
internationalcentre